

ASSEMBLY INSTRUCTION

BOOTY BUILDER V8

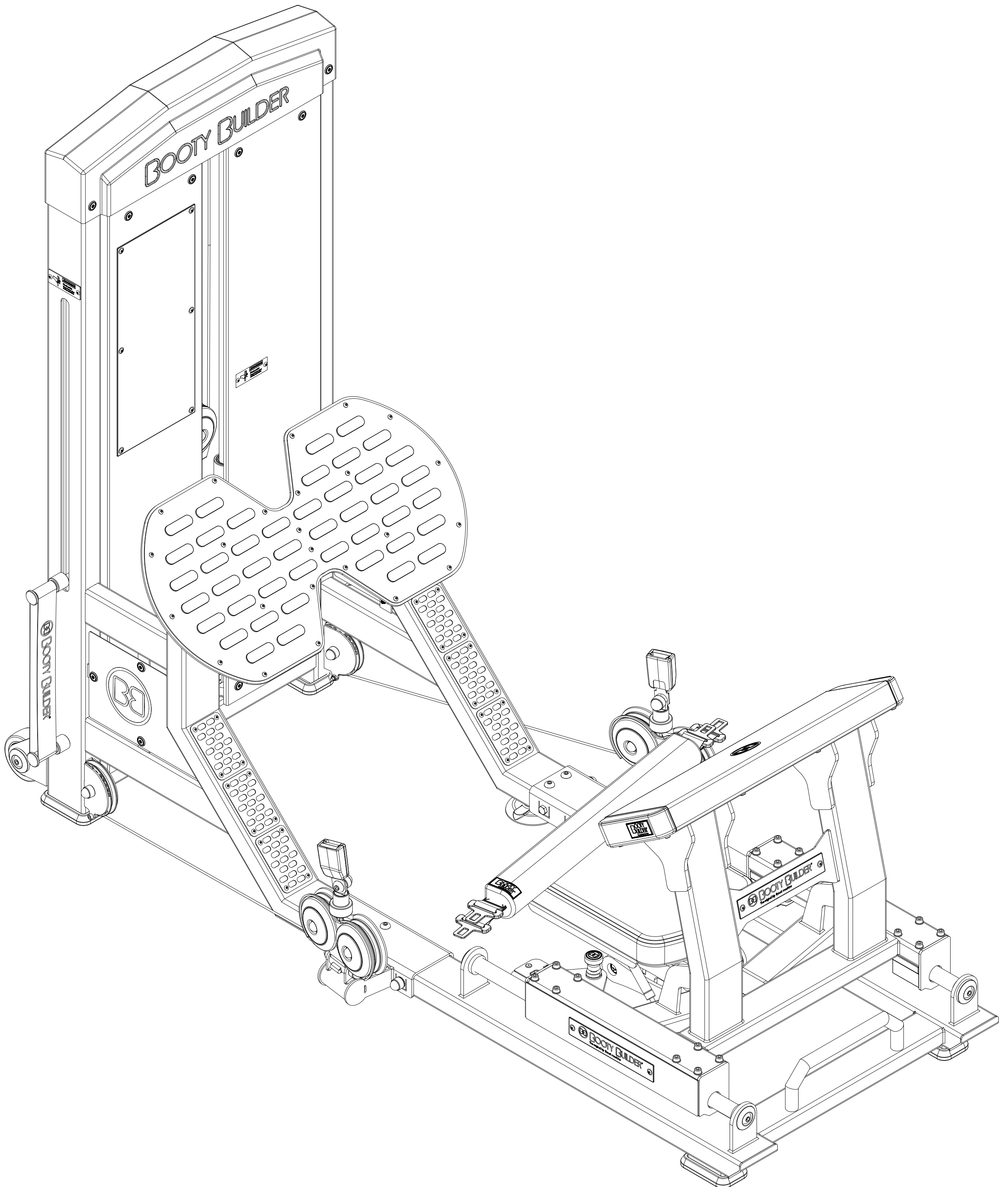

BEFORE ASSEMBLY

- ▶ This must be read before you start assembling this unit.
- ▶ You must follow the assembly instructions exactly as outlined.
- ▶ Assemble this unit starting at the beginning and work to the end
- ▶ The assembly instructions are set out so that you are only doing one section at a time, therefore you will finish one section and move on to the next.
- ▶ If something is missing when assembling this unit, you must notify us of the part number of the exact nut, bolt or part that is missing.
- ▶ To help you assemble this unit we have used line drawings.
- ▶ Check the line drawings for the exact positioning of the parts.
- ▶ The unit will need to be checked at least once a week for nuts and bolts that can work loose, upholstered pieces working loose and wear on pivot assemblies.

TOOLS NEEDED

KEY FLAT EYE
19x2
17x1



HEX KEY
8



Screwdriver (Cross)



STEP 1

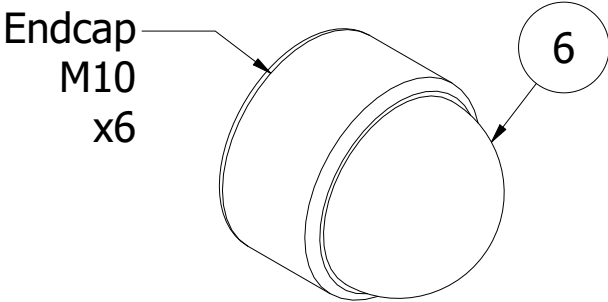
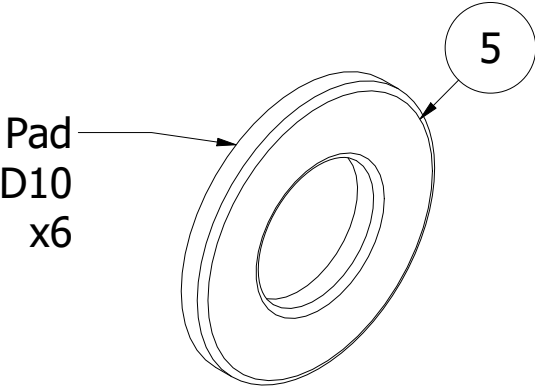
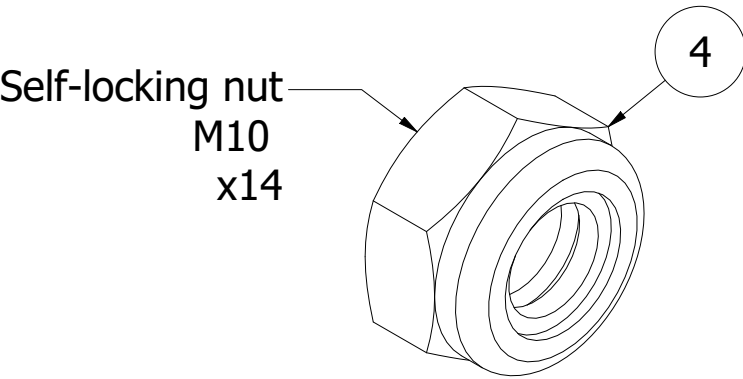
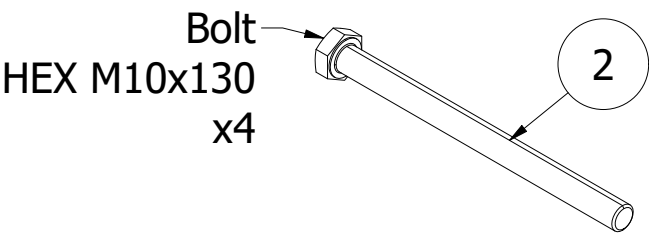
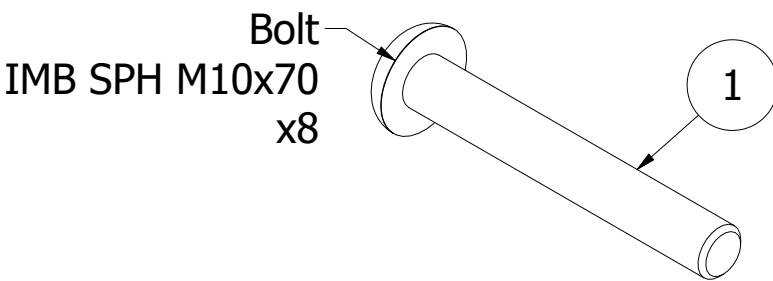
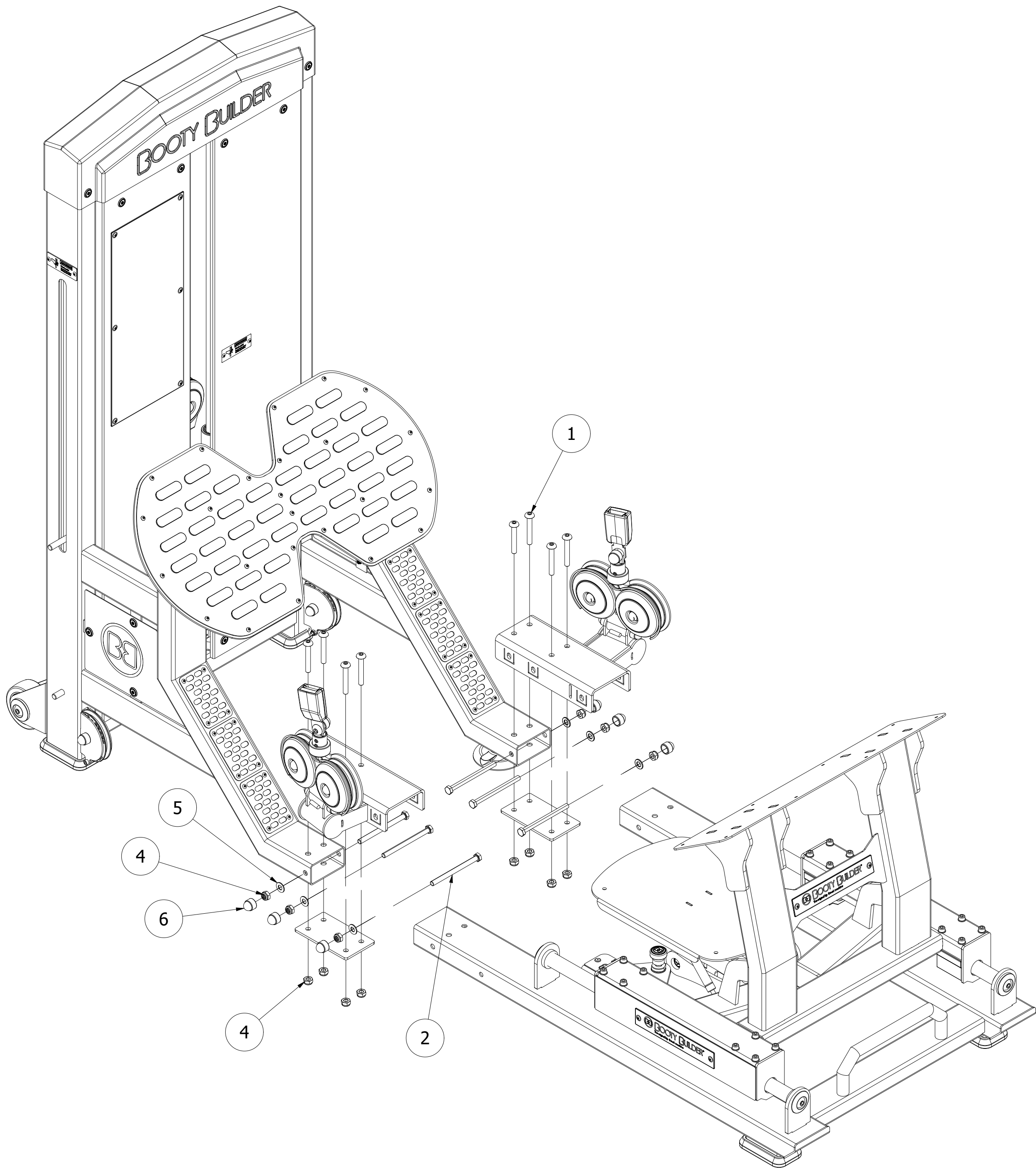

STEP 2

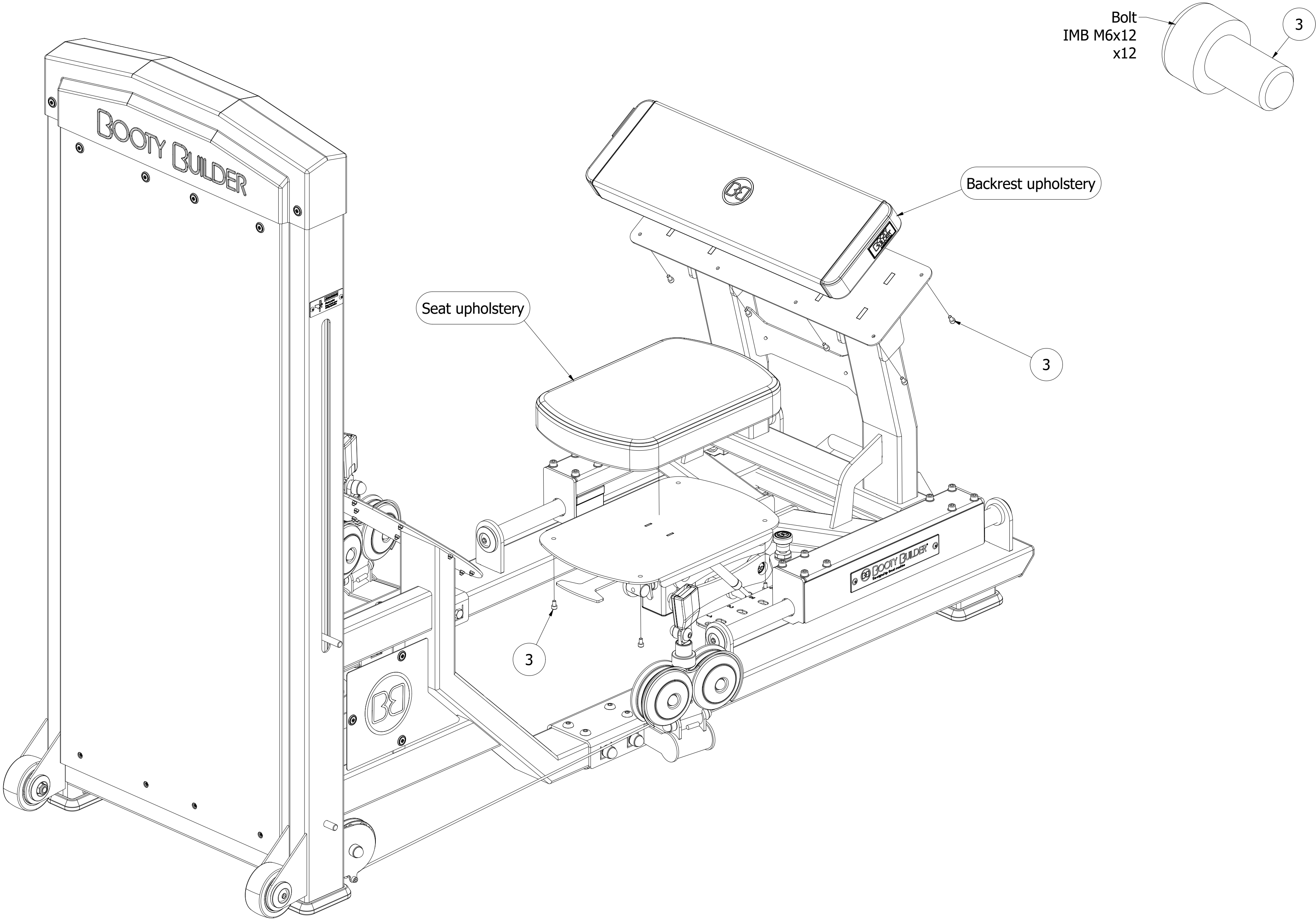

STEP 3

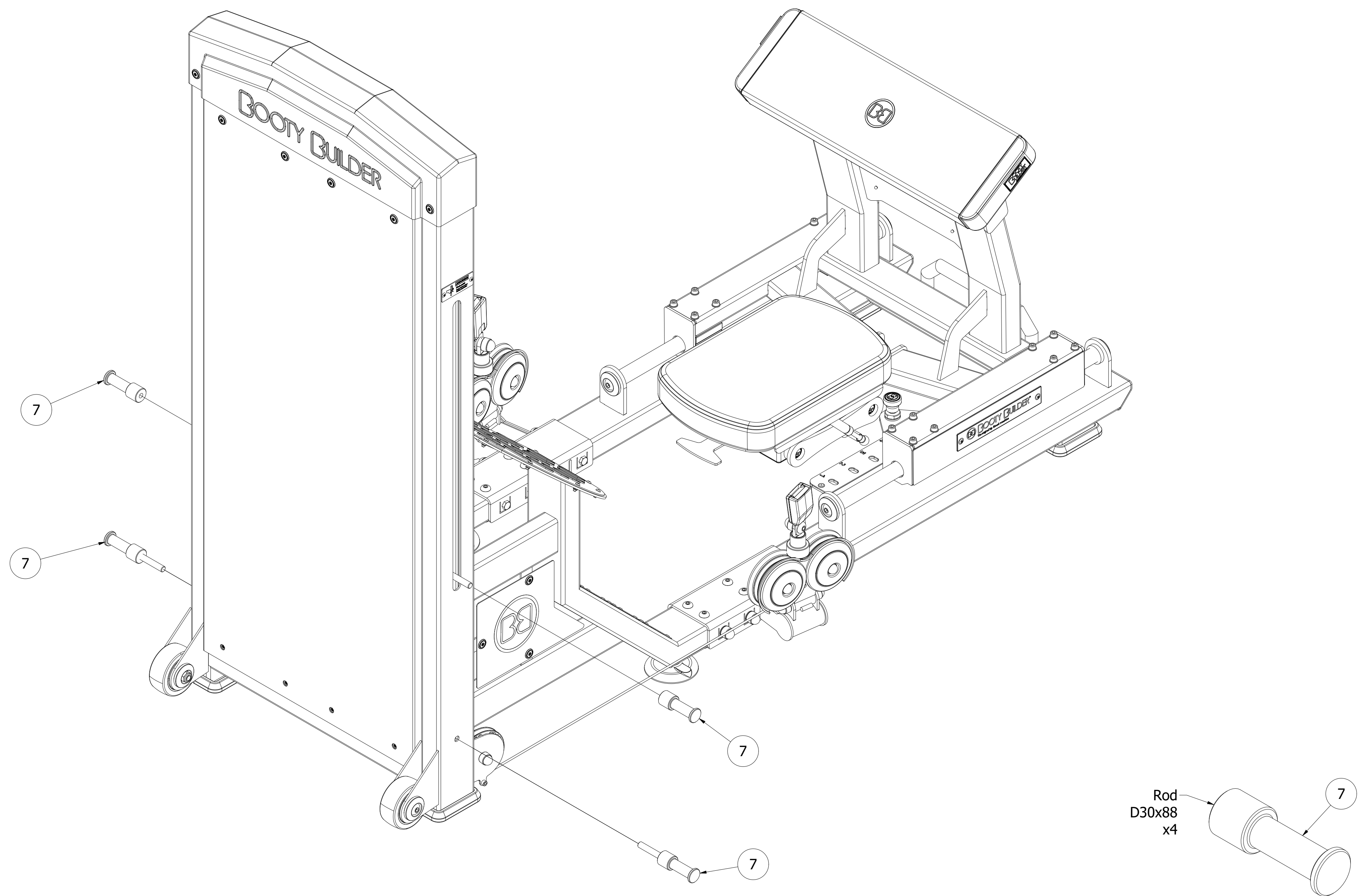

Stack cable tensioning

1

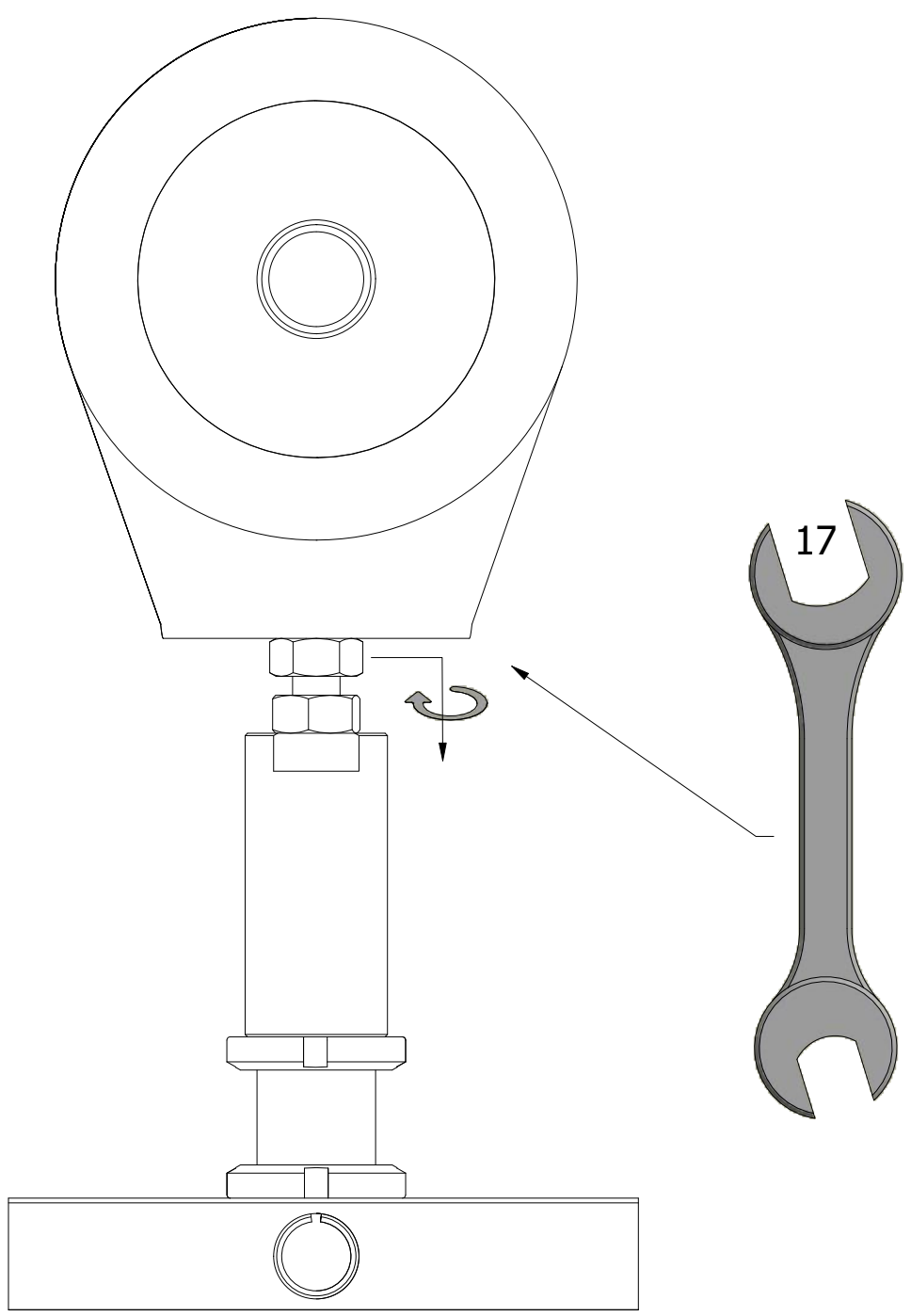

2

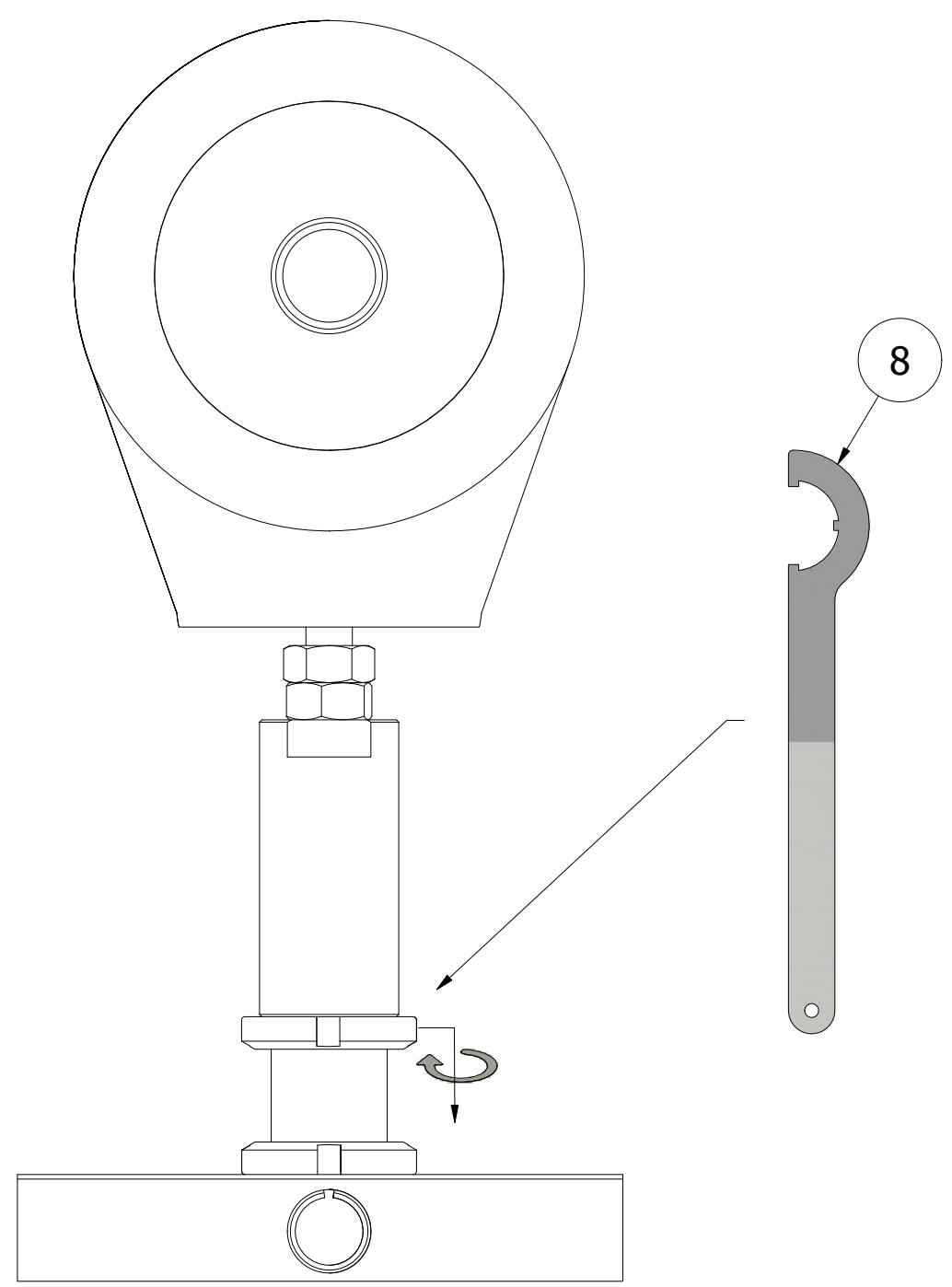

3

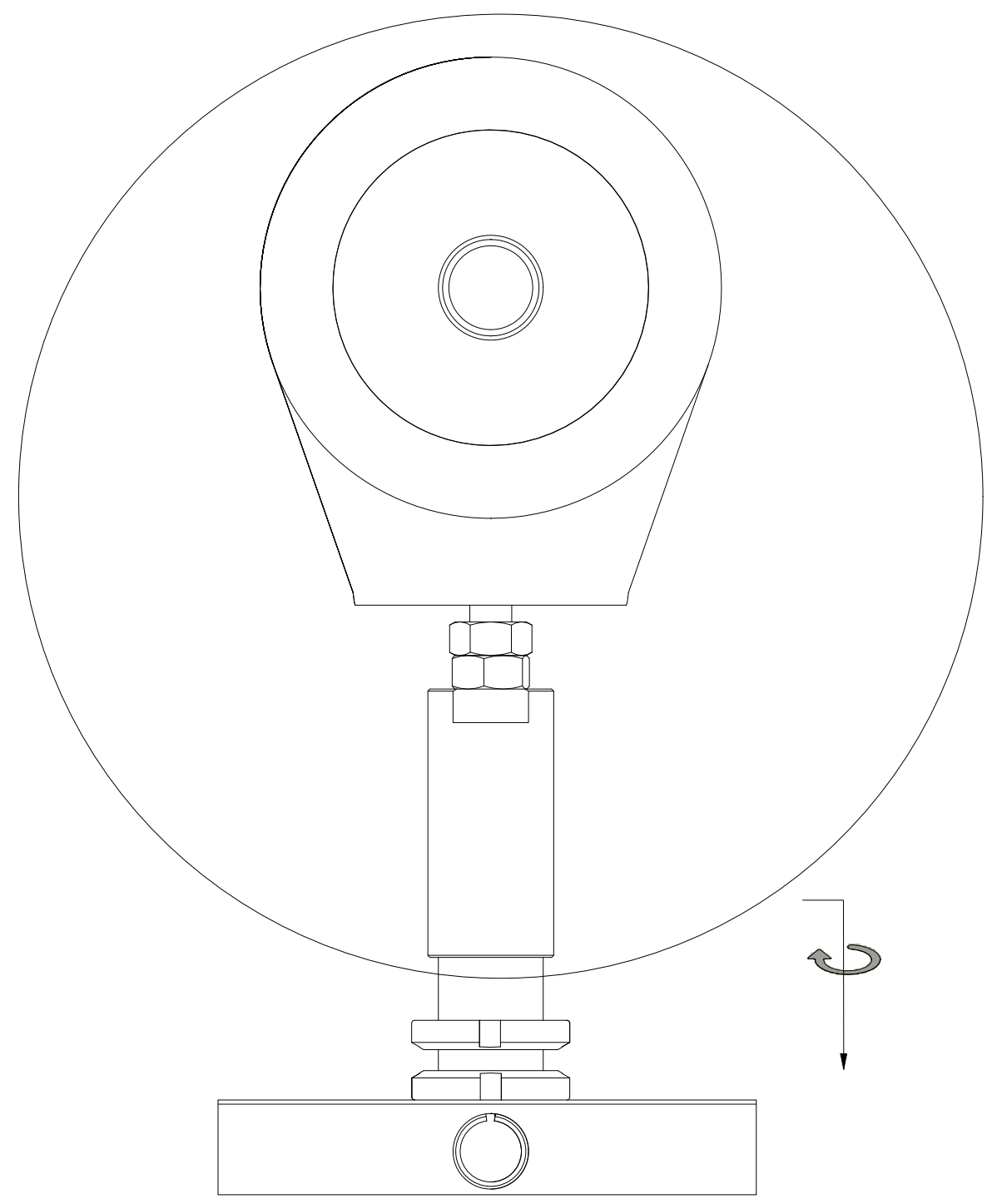

4

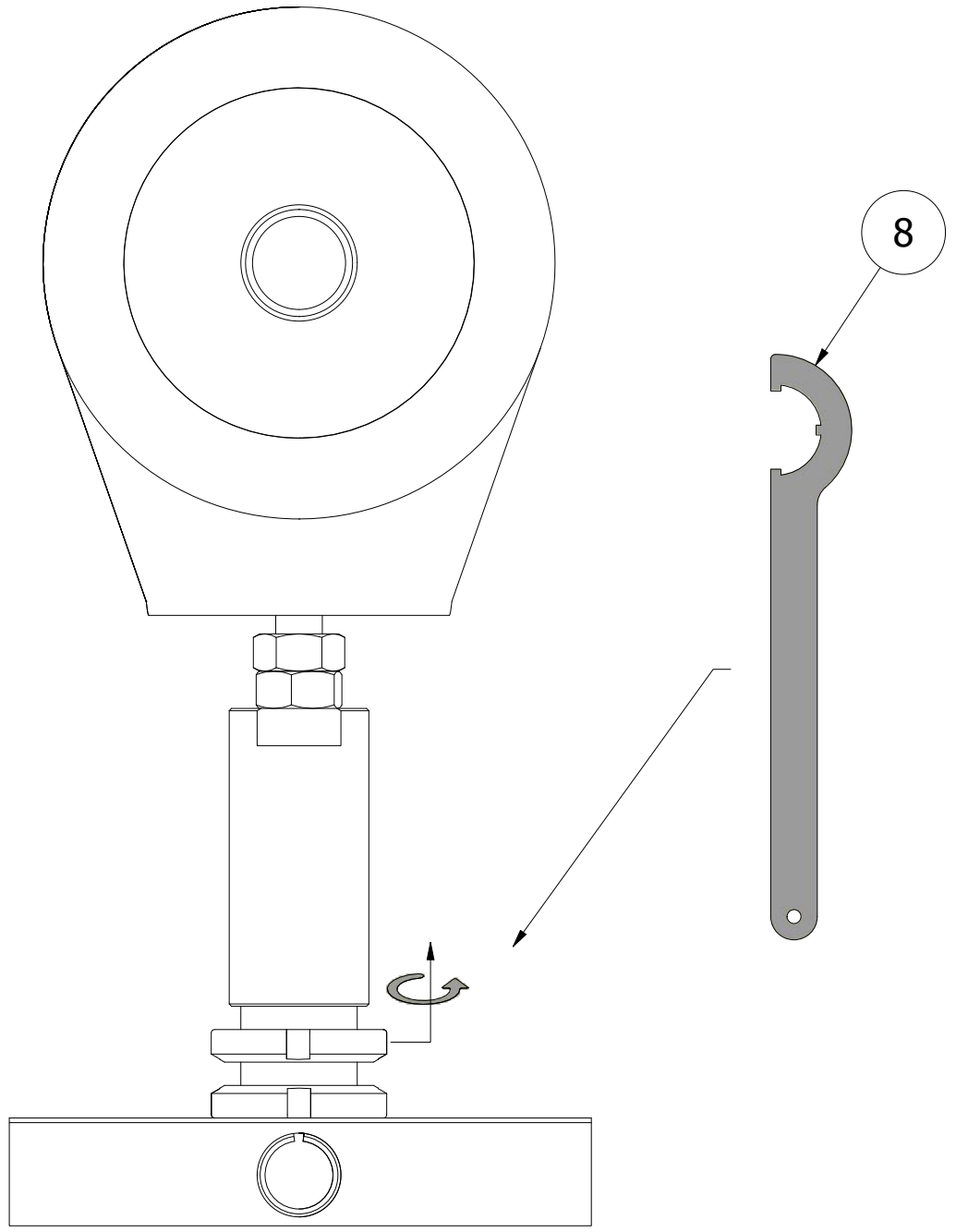

5

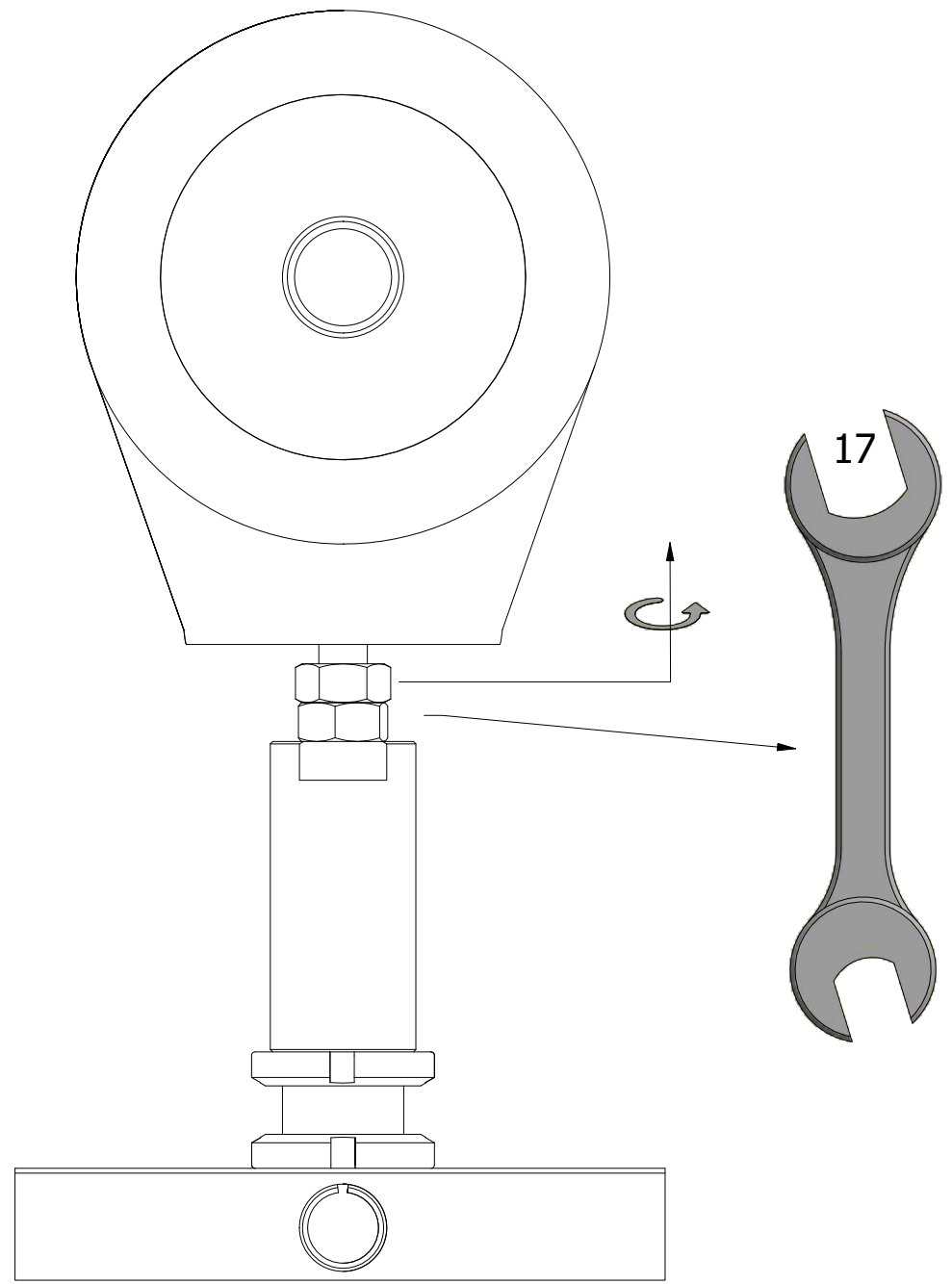

6

